

Tulli Zuccari

Tulli Zuccari

Tulli Zuccari srl si riserva il diritto di apportare in qualsiasi momento modifiche tecniche, costruttive, dimensionali utili al miglioramento dei propri prodotti, senza obbligo di preavviso di sostituzione. Si riserva altresì la possibilità di sopprimere, a suo insindacabile giudizio, i prodotti che più riterrà opportuni nonché di aggiungerne di nuovi senza preavviso.

Tulli Zuccari srl reserves the right to make technical, constructional, and size modifications at any time for the purpose of improving its products without notice and without obligation to make substitutions. It also reserves the right, solely at its own discretion and without advance notice, to eliminate products as necessary and to add new ones.

Thanks to Rubinetterie Ritmonio srl

Per maggiori informazioni e per scaricare i cataloghi in formato pdf visitate il sito/
For further information and to download pdf format catalogues, please visit the website:
www.tullizuccari.com

progetto fotografico /photographic project

Ricciarelli.it

progetto grafico e coordinamento/graphic design and project management

ADV creativi • an

fotografia e stampa /photography and print

Ricciarelli.it

ph Francesco Bottegal

Tulli Zuccari art director

Emanuele Montanelli

www.emanuelemontanelli.com

Località Fossa Renosa | Zona Industriale

06031 Bevagna (PG) ITALY

T +39 0742 362040 | F +39 0742 361936

www.tullizuccari.com | info@tullizuccari.com



Tulli Zuccari



MARATHI H40
F3 grigio spento 22S
F1 rovere naturale RN

06

ROMINA H40
F3 polvere 13L
F4 blu 06

26



MARATHI H40
F3 bianco 01L

10

ROMINA H 40
F9 pergamon 08L
F4 rosa 52 / Mineralmarmo
AKIO: F3 pergamon 08L

30

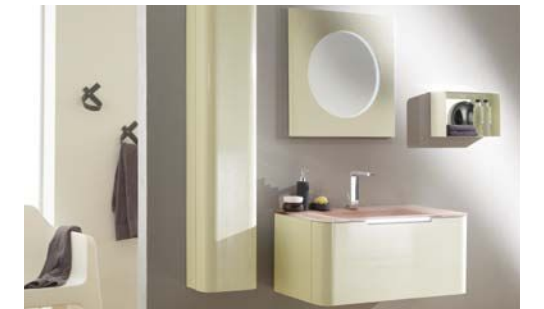

MARATHI MONOLITE
F3 rosso intenso 07L

14

ROMINA H40
F3 caffè 19S
Mineralmarmo
AKIO: F3 bianco 01S

32



MARATHI MONOLITE
F6 black and white HPL3
F3 bianco 01L + nero 02L

18

ELBA
F7 TSS gray LM69
F4 arancione 36

38



MARATHI
F7 TSS brown LM09

20

ELBA
F10 bianco A001
F4 nero 02 / Mineralmarmo

40



SEZIONE TECNICA
TECHNICAL SECTION
SECTION TECHNIQUE
TECHNISCHER TEIL
SECCIÓN TÉCNICA
ТЕХНИЧЕСКАЯ ИНФОРМАЦИЯ

42

FINITURE
FINISHES
FINITIONS
AUSFÜHRUNGEN
COLORES
ВАРИАНТЫ ОТДЕЛКИ

48

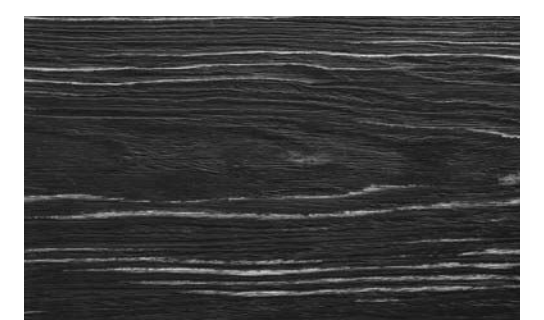

MARATHI





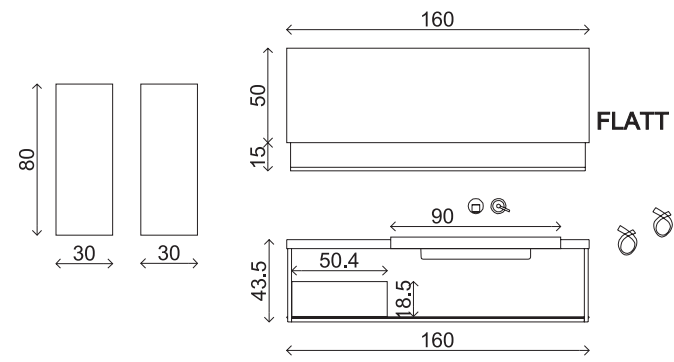

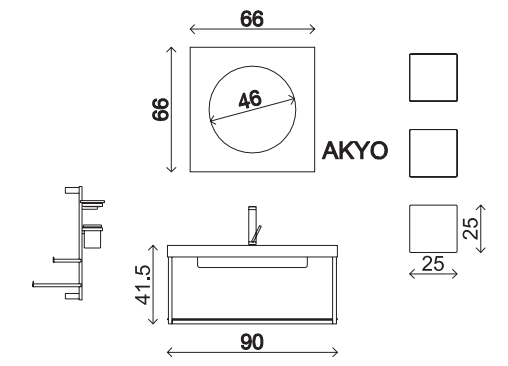





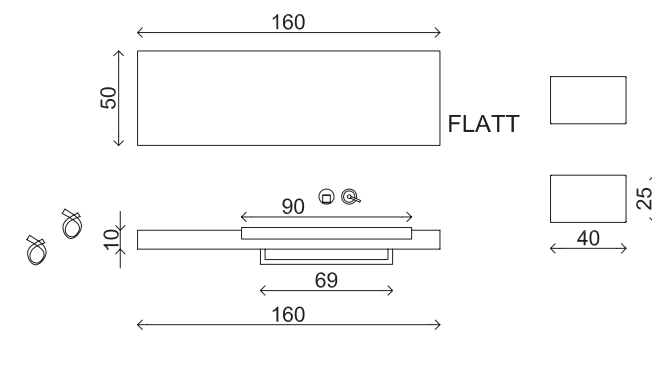

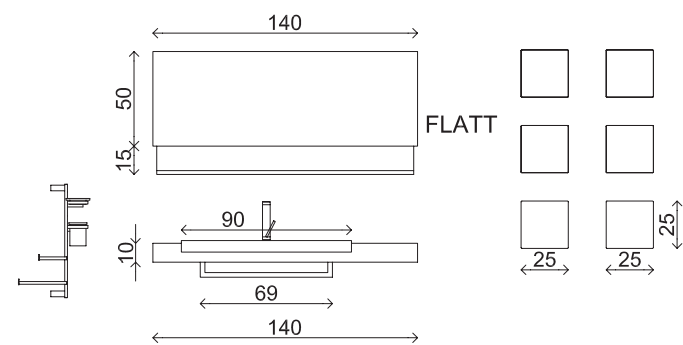



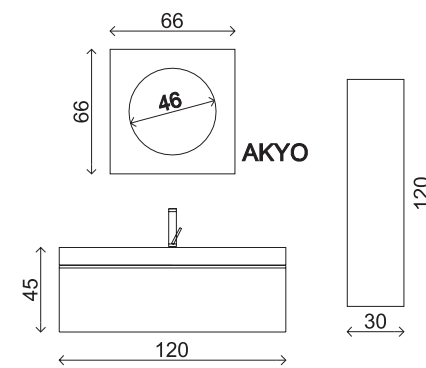

ROMINA





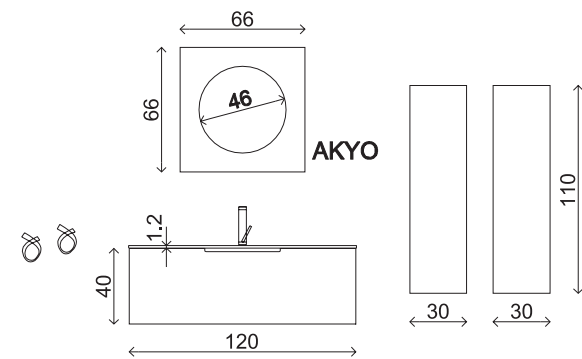

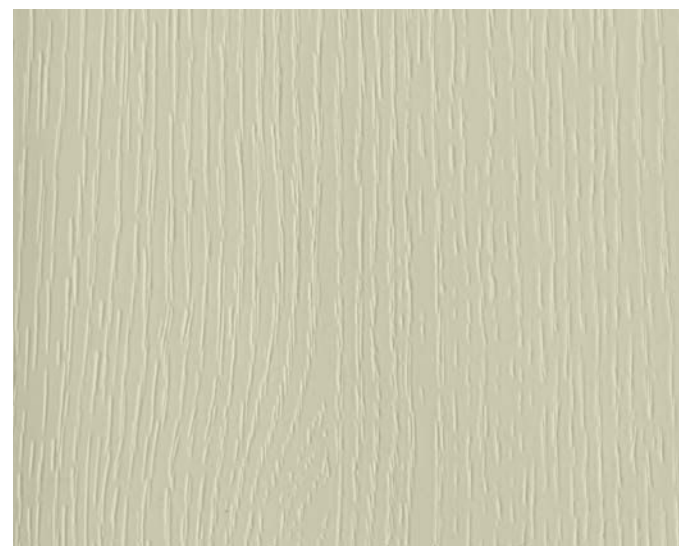
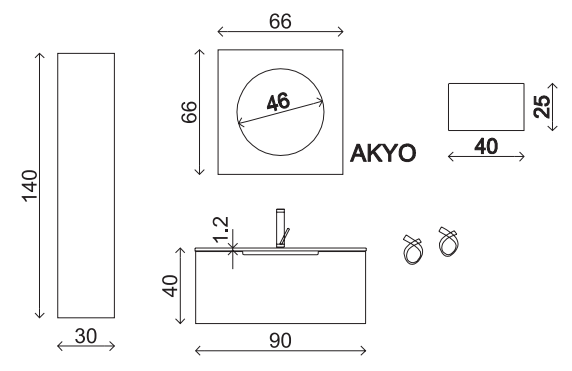



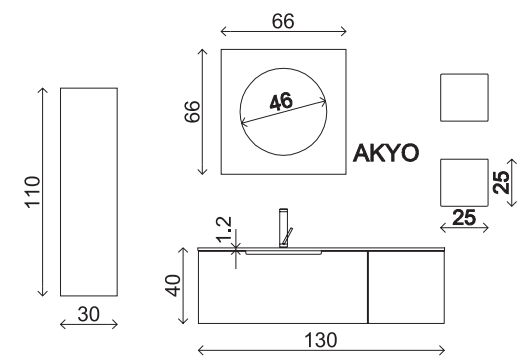

ELBA



ELBA
design by TZZD

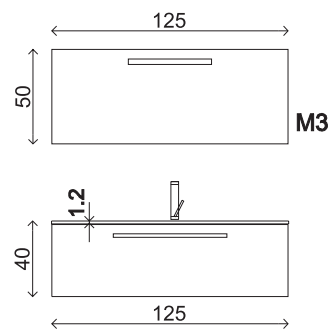

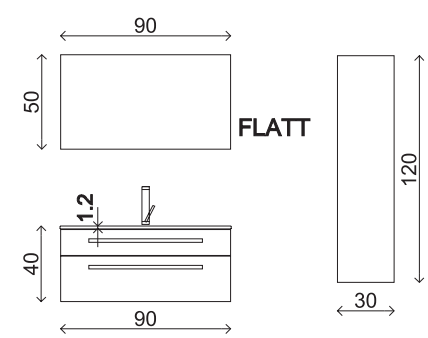

NOTA IMPORTANTE

Le finiture qui rappresentate sono indicative e possono presentare differenze anche sostanziali rispetto alla realtà. Pertanto, prima di inoltrare l'ordine, è necessario che il cliente verifichi la finitura scelta nel campionario materiali e colori Tulli Zuccari.

IMPORTANT NOTE

The finishes represented here are just an indication and they can present some substantial differences from the real product. Before placing an order, please make sure the client checks the choosen finish amongst the Tulli Zuccari samples and colours.

NOTE IMPORTANTE

Les finitions présentées sont indicatives et peuvent présenter des différences dans la réalité. Il convient au moment de la commande de demander un échantillon des matériaux et des coloris auprès de Tulli Zuccari.

WICHTIGER HINWEIS

Die hier dargestellten ausführungen sind indikativ und können von den effektiven ausführungen abweichen. Daher ist es wichtig die ausführungen anhand der material- und farbmuster von Tulli Zuccari auszusuchen.

NOTA IMPORTANTE

Los colores representados aquí son aproximados y pueden diferir materialmente de la realidad. Por lo tanto, antes de realizar su pedido, el cliente tiene que verificar el color elegido con las muestras de los materiales y colores Tulli Zuccari.

ВАЖНО

ПРЕДСТАВЛЕННЫЕ ЗДЕСЬ ВАРИАНТЫ ОТДЕЛОК ЯВЛЯЮТСЯ ОРИЕНТИРОВОЧНЫМИ И МОГУТ ОТЛИЧАТЬСЯ, В ТОМ ЧИСЛЕ ЗНАЧИТЕЛЬНО, ОТ РЕАЛЬНЫХ. ПЕРЕД ТЕМ КАК СДЕЛАТЬ ЗАКАЗ, ВАЖНО ЧТОБЫ КЛИЕНТ УТВЕРДИЛ ВЫБРАННЫЙ ВАРИАНТ ОТДЕЛКИ ПО ОБРАЗЦАМ ТУЛЛИ ЗУККАРИ.

SEZIONE TECNICA

TECHNICAL SECTION

SECTION TECHNIQUE

TECHNISCHER TEIL

SECCIÓN TÉCNICA

ТЕХНИЧЕСКАЯ ИНФОРМАЦИЯ

MARATHI

design Emanuele Montanelli

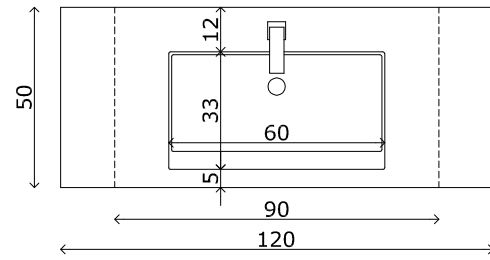
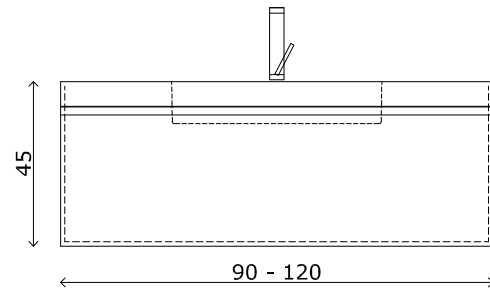
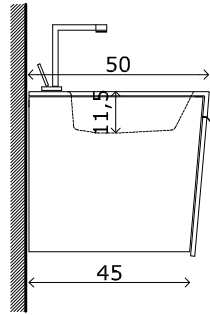

MARATHI MONOLITE

design Emanuele Montanelli

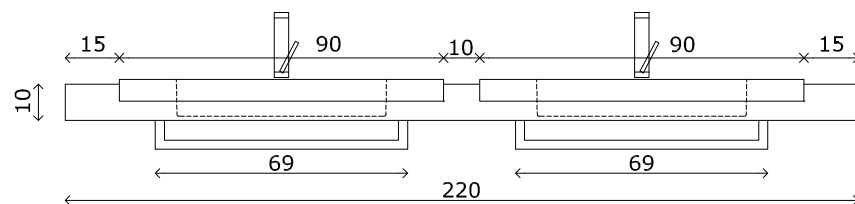
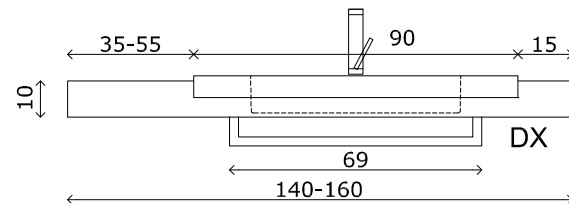
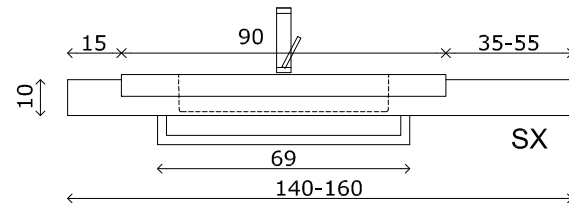
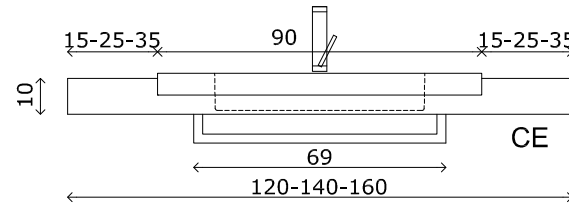
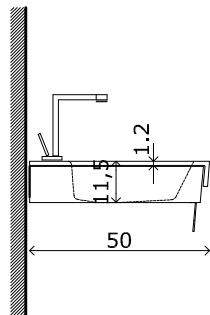

MARATHI H40

design Emanuele Montanelli

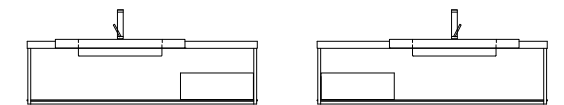
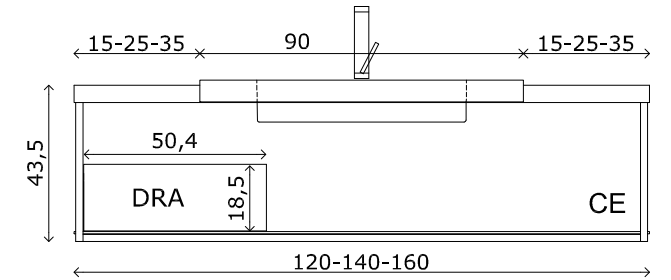
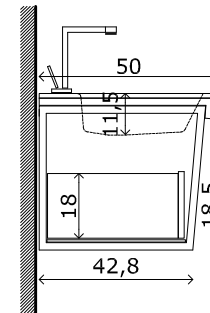
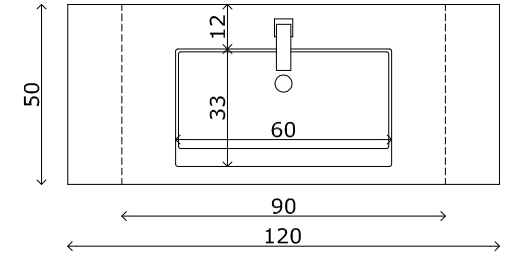
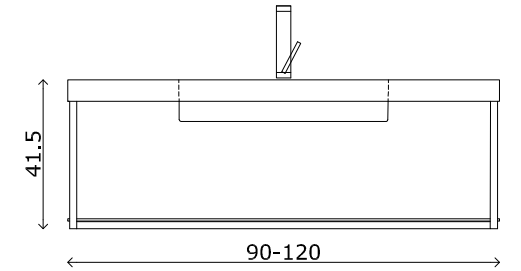
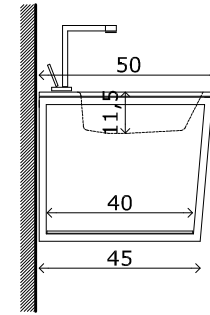

DRA: CASSETTO / DRAWER / TIROIR
SCHUBLADE / CAJÓN / ВЫДВИЖНОЙ ЯЩИК

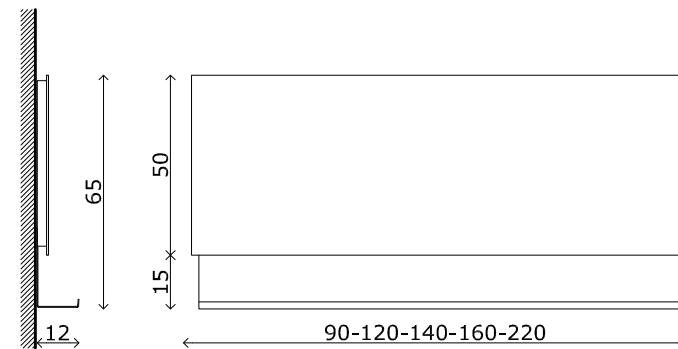

FLATT

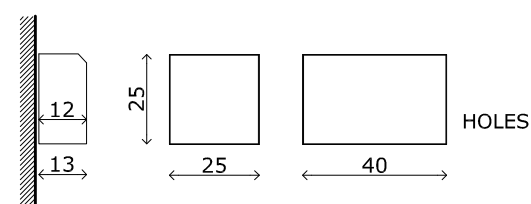
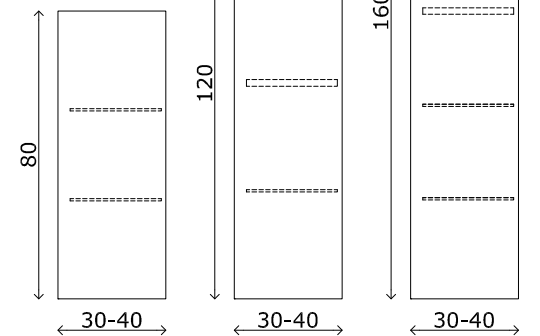

ROMINA H40

design TZDD

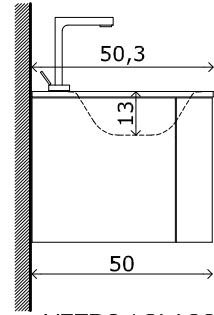

VETRO / GLASS / VERRE
KRISTALGLAS / CRYSTAL
/ СТЕКЛО

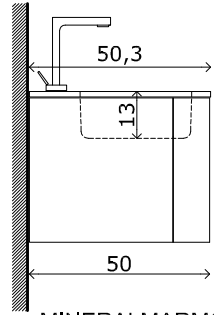

MINERALMARMO

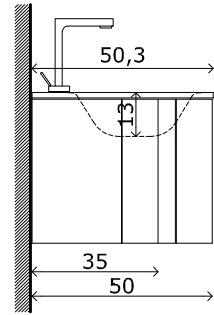

VETRO / GLASS / VERRE
KRISTALGLAS / CRYSTAL
/ СТЕКЛО

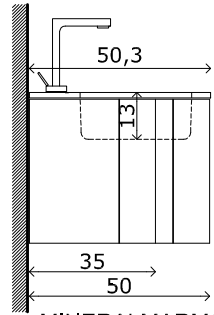

MINERALMARMO

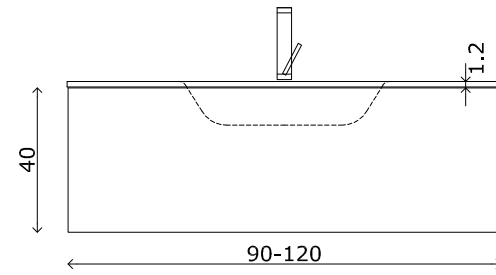
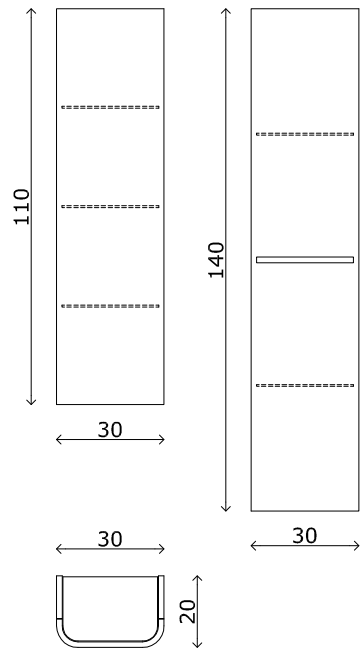

VETRO / GLASS / VERRE
KRISTALGLAS / CRYSTAL / СТЕКЛО

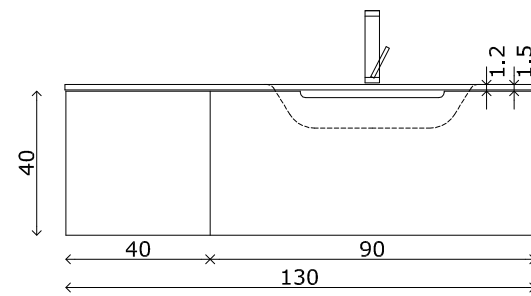
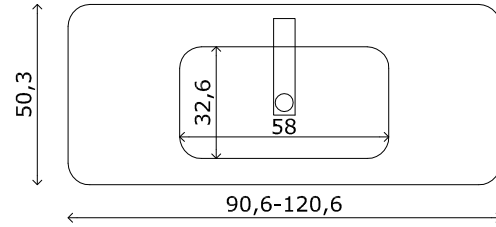

VETRO / GLASS / VERRE
KRISTALGLAS / CRYSTAL / СТЕКЛО

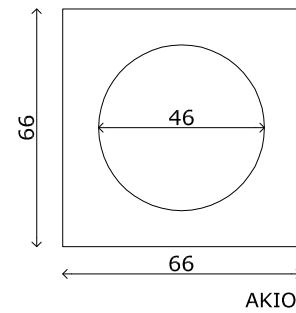
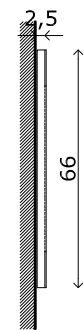
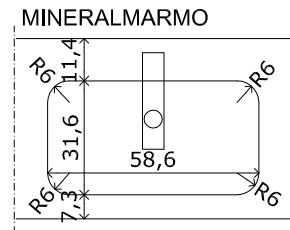
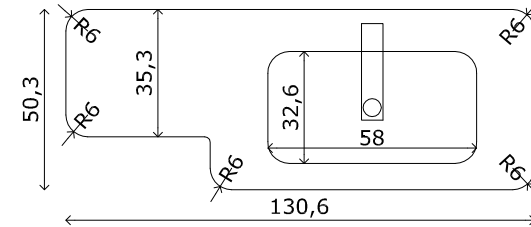

ELBA

design TZDD

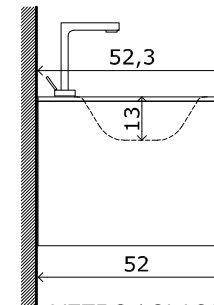

VETRO / GLASS / VERRE
KRISTALGLAS / CRYSTAL
/ СТЕКЛО

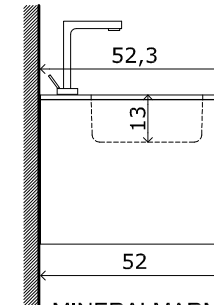

MINERALMARMO

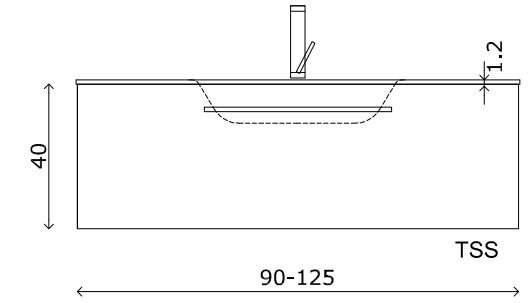

TSS

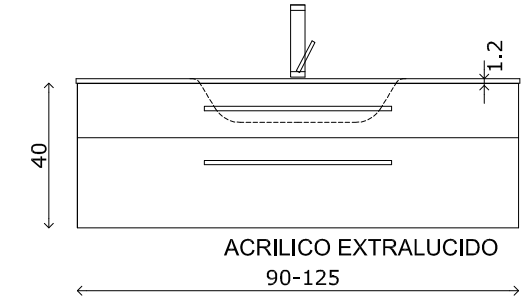

ACRILICO EXTRALUCIDO
90-125

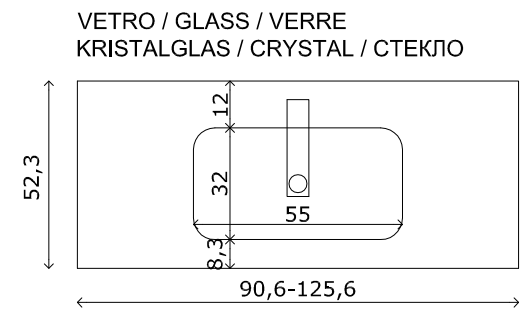

VETRO / GLASS / VERRE
KRISTALGLAS / CRYSTAL / СТЕКЛО

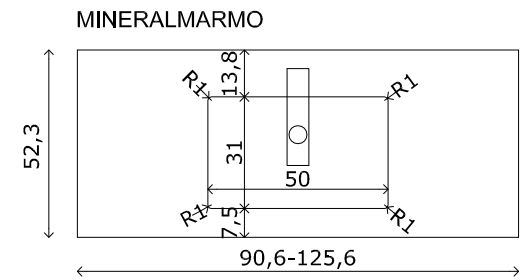

MINERALMARMO

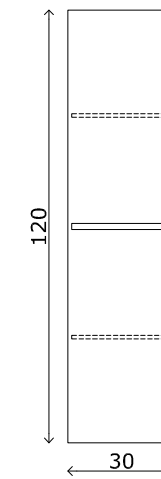

LAMINATI HPL

HIGH PRESSURE LAMINATE HPL | BOIS LAMINÉ HPL | LAMINAT HPL
LAMINADO HPL | ЛАМИНИРОВАННОЕ ДЕРЕВО



Rovere
naturale
HPL1



Rovere
moro
HPL2

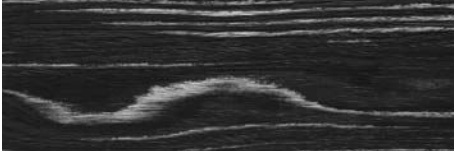

Black and
White
HPL3

ACRILICO EXTRALUCIDO

EXTRAGLOSSY ACRYLIC | ACRILICO SUPER-BRILLANT | ACRILICO HOCHGLÄNZEND
ACRÍLICO SÚPER BRILLANTE | АКРИЛ ЭКСТРА БЛЕСК

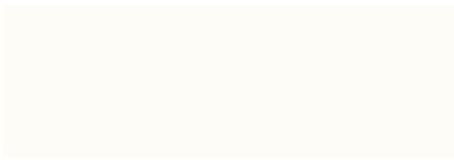

Bianco
A001



Nero
A012



Rosso
A006



Grafite
A025